

1.General Information

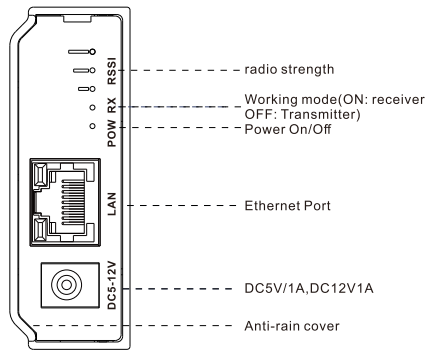

01

2.Plug and play ,automatic connected

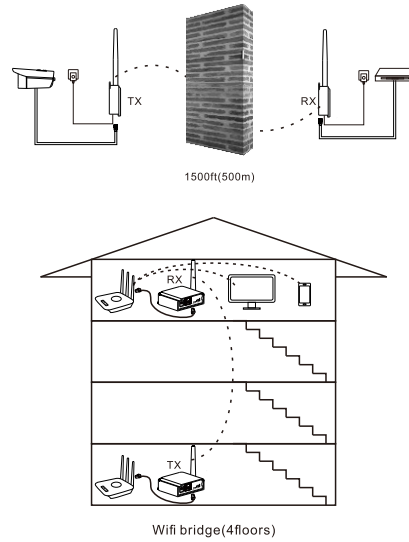

02

3.Install the Ethernet Air

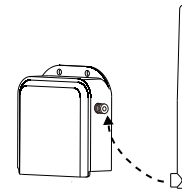

1.Plug in the antenna

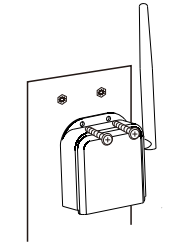

Drill the hole and screw the Ethernet Air on the wall

03

4.Install the Ethernet Air

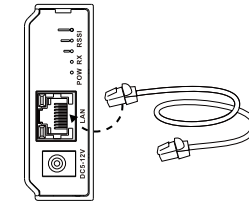

3.Plug in the RJ45 Cable

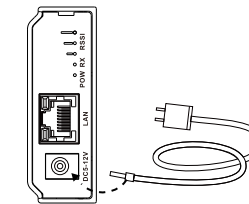

Plug in the power supply

04

5.Before you begin Check out all

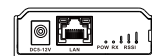

Ethernet Air X1



Self tapping screwX2



Colloidal particlesX2



Ethernet CableX1



5V1A power adapterX1



Omnidirectional antennaX1

05

6.Detail Technical Specifications

- Connectivity: Wi-Fi Halow security protocol
- Transmission Distance: Max 3000ft with the 1080P video
- Penetration Ability: 3-4 concrete walls
- Power: 5V/1A DC
- Operation Temperature: -5°F-120°F(-20°C-48°C)
- Size: 300mmX190mmX75mm
- Antenna: length 19cm with 2dbi gain
- Warranty: 12 months Parts and Lifetime Purchase Protection
- FCC ID: 2AXPI-TX-AH-R900ATR

06

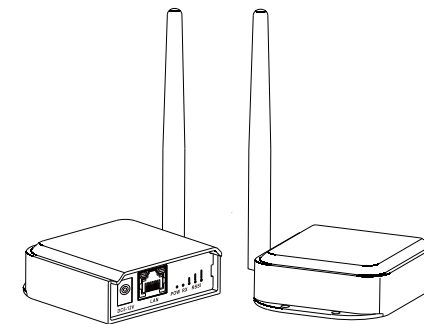

Version 1.0.0

Wireless Signal Wall-through Ethernet Connector -- ETHERNET AIR

Wireless Signal Wall-through Ethernet Connector -- ETHERNET AIR

First omnidirectional Antenna Network Bridge with 3000ft transmission distance